

ABOARD

# Le Ponant

WITH ZEGRAHM EXPEDITIONS

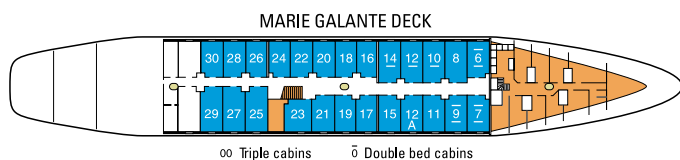
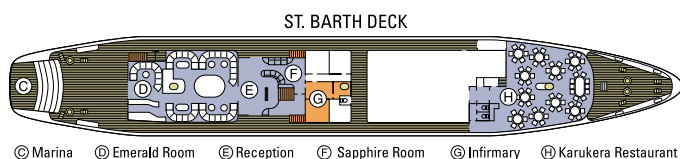
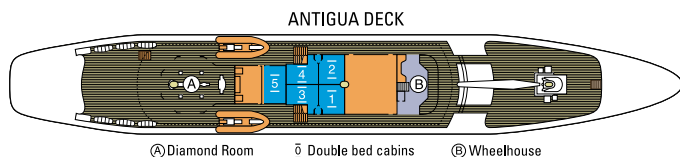
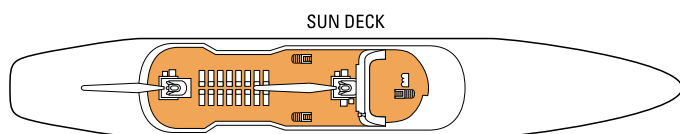

## LE PONANT

*Le Ponant* is a sleek, three-masted sailing vessel that is ideal for expedition cruising. While her engines provide 10-knot speeds, when her 16,140-square-foot sails are unfurled, *Le Ponant* glides through the water at 10–12 knots. The four-deck vessel has ample deck space, and is fully equipped with two restaurants, lounge, bar, and book/video room. She has all outside cabins, each with en suite bathroom, minibar, safe, radio, individual air conditioning control, and telephone. *Le Ponant* carries Zodiacs aboard and has capabilities for snorkeling and diving. **DETAILS ▶**

## SHIP SPECIFICATIONS

Built:	1991
Gross Tonnage:	1,490
Length:	290 feet
Draft:	13 feet
Beam:	39 feet
Number of Guests:	56
Crew Members:	30
Crew Nationality:	French and Filipino
Ship's Registry:	France

## FACT SHEET



### GENERAL

---

- Four decks of passenger facilities.
  - Sun Deck – large open space with deck chairs available. Great for viewing the sails.
  - Antigua Deck – passenger cabins and the al fresco Diamond Restaurant.
  - St. Barth Deck – lounge for lectures and recaps, bar, Karukera formal dining room, and reception.
  - Marie Galante Deck – passenger cabins for double and triple accommodations.
- Stairs connect the decks (no elevator).
- There is an open-bridge policy, contingent upon weather and navigation conditions.
- Smoking is allowed on outside decks only.

### CABINS

---

- Cabins are similar in amenities and average 160 square feet.
- All cabins have: hair dryer, direct dial phone for international calls and cabin-to-cabin calls, safe deposit box, an intercom system for announcements, at least one closet and one shelf unit, European-type outlets (two round sockets) at 220 volts, individual heat/air conditioning controls, a minibar, and complimentary bottled water.
- Ocean view: cabins on Antigua deck have a window (approximately 2 feet by 2 feet); Marie Galante cabins have a large porthole.
- All cabins have lower beds. The bed configuration varies from two twins to one double. Several cabins are capable of holding a third passenger. Cabins 1–5 (Antigua deck), 6, 7, and 9 have one double bed; cabins 10, 12, and 14 have one double bed and a convertible sleeper sofa; and all other cabins have two lower twin beds that can be moved together into one queen bed.

### DINING

---

- Each restaurant holds all 56 passengers at one seating.
- Special dietary requests can be fulfilled with advance notice.
- The Diamond Restaurant serves lunch and breakfast; dinner is served in the Karukera Restaurant.
- Room service for breakfast is available with advance request.

### SERVICES

---

- Snorkel gear and beach towels are available for all passengers free of charge.
- Weights and tanks are available for certified divers. All divers must bring any additional equipment.
- *Le Ponant* carries a fleet of Zodiacs.
- A doctor and a small infirmary are available on board. Rates are posted.
- Laundry services are available (no dry cleaning). Rates are posted. No beauty salon on board.
- Small glass cases showcase *Le Ponant* ship and trip memorabilia for sale.
- Due to the active nature of the expeditions, no pool, gym, or sauna facilities are available.
- The Sapphire Room is a small lounge area behind reception that offers a small library and a TV/VCR for public use.
- The euro is the currency used on board. Most credit cards and travelers checks are accepted for payment of shipboard accounts.